

# SPECIAL EDUCATION CENTERS

## SPECIAL EDUCATION CENTERS

### Longview School

Longview School provides services to students aged 5–21 with severe to profound intellectual disabilities and multiple disabilities. Alternate Academic Learning Outcomes aligned to the general education framework are utilized to provide students with skills in the areas of communication, mobility, self-help, functional academics, and transition services. Longview School is collocated with Spark Matsunaga Elementary School in the Northwest Cluster.

### John L. Gildner Regional Institute for Children and Adolescents (RICA)

The John L. Gildner Regional Institute for Children and Adolescents (RICA), in collaboration with the Maryland State Department of Health and Mental Hygiene, provides appropriate educational and treatment services to students and their families through highly structured intensive special education services with therapy integrated in a day and residential treatment facility. An interdisciplinary treatment team, comprised of school, clinical, residential, and related service providers, develops the student's total educational plan and monitors progress. Consulting psychiatrists, a full time pediatrician, and a school community health nurse also are on staff.

RICA offers fully accredited special education services that emphasize rigorous academic and vocational/occupational opportunities; day and residential treatment; and individual, group, and family therapy. The RICA program promotes acquisition of grade and age appropriate social and emotional skills and allows students to access the general education curriculum.

### Rock Terrace School

Rock Terrace School is comprised of a middle, high, and upper school program. The instructional focus of the middle school is the implementation of Alternate Learning Outcomes aligned to the general education framework to prepare the students for transition to the high school program. The high school program emphasizes the Alternate Learning Outcomes aligned to the general education framework and community-based instruction activities that enable students to demonstrate skills that lead to full participation in school-to-work and vocational/community experiences. Authentic jobs help in reinforcing classroom learning. The upper school prepares students for post-secondary experiences and career readiness.

**Capital Project:** A revitalization/expansion project is scheduled for this school with a completion date of September 2020. On May 12, 2015, the Board of Education approved the collocation of Rock Terrace School with Tilden Middle School as part of the revitalization/expansion project. An FY 2018 appropriation was approved to begin the site work for this project. In order for this project to be completed on this schedule, county and state funding must be provided at the levels approved in this CIP.

Tilden Middle School is currently located in the Woodward facility on Old Georgetown Road. Rather than revitalize/expand the Woodward facility for Rock Terrace School and Tilden Middle School, the current Tilden Holding Facility, located on Tilden Lane, will be revitalized/expanded to house both Rock Terrace School and Tilden Middle School.

An FY 2019 appropriation was approved to construct the project. In order for this project to be completed on this schedule, county and state funding must be provided at the levels approved in this CIP.

### Carl Sandburg Learning Center

Carl Sandburg Learning Center is a special education school that serves students with multiple disabilities in kindergarten through Grade 5, including intellectual disabilities, autism spectrum disorders, language disabilities, and emotional or other learning disabilities. Services are designed for elementary students who need a highly structured setting, small student-to-teacher ratio, and access to the MCPS general education framework or Alternate Learning Outcomes aligned to the general education framework. Modification of curriculum materials and instructional strategies based on students' needs is the basis of all instruction. Emphasis is placed on the development of language and academic and social skills provided through an in-class transdisciplinary model of service delivery in which all staff members implement the recommendations of related service providers. Special emphasis is placed on meeting the sensory and motor needs of students in their classroom setting. To address behavioral goals, services may include a behavior management system, psychological consultation, and crisis intervention.

**Capital Project:** On November 17, 2011, the Board of Education approved the collocation of Carl Sandburg Learning Center on the Maryvale Elementary School campus when the revitalization/expansion project is complete. A revitalization/expansion project is scheduled for this school with a completion date of September 2020. An FY 2018 appropriation was approved to begin construction for this project. In order for this project to be completed on this schedule, county and state funding must be provided at the levels approved in this CIP.

### Stephen Knolls School

The Stephen Knolls School serves students aged 5–21 with severe to profound intellectual disabilities and multiple disabilities. Alternate Learning Outcomes aligned to the general education framework are utilized to provide students with skills in the areas of communication, mobility, self-help, functional academics, and transition.

## SPECIAL EDUCATION CENTERS

### CAPITAL PROJECTS

| School                        | Project   | Project Status* | Date of Completion |
|-------------------------------|---|-----------------|--------------------|
| Rock Terrace School           | Revitalization/ expansion with collocation at Tilden MS   | Approved        | Sept. 2020         |
| Carl Sandberg Learning Center | Revitalization/ expansion with collocation at Maryvale ES | Approved        | Sept. 2020         |

\*Approved— Project has an FY 2019 or FY 2020 appropriation for planning or construction funds approved in the Amended FY 2019–2024 CIP.

Programmed—Project has expenditures programmed in a future year of the CIP for planning and/or construction funds.

Proposed—Project has facility planning funds approved for a feasibility study.

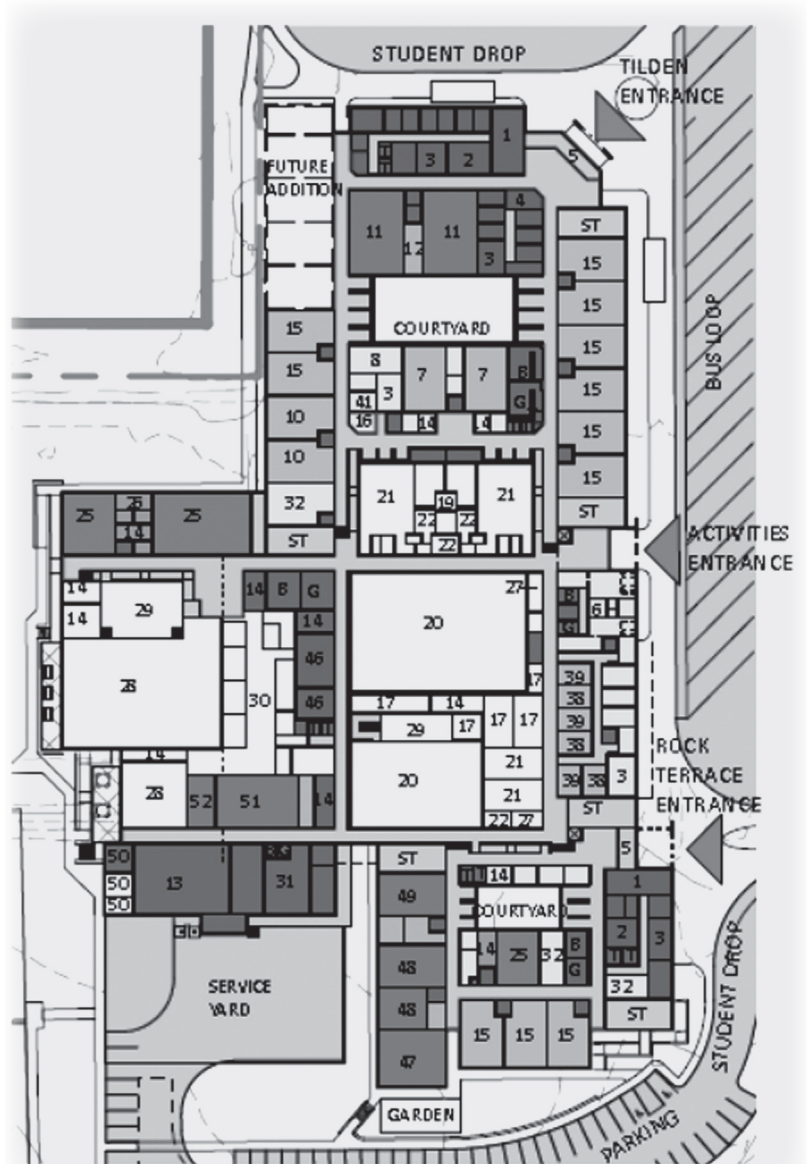

## SPECIAL EDUCATION CENTERS

### Projected Enrollment and Space Availability

Effects of the Adopted Amendments to the FY2019–2024 CIP and Non-CIP Actions on Space Availability

| Schools               |  |                  | Actual | Projections               |                 |       |       |       |       | 2028 | 2033 |
|-----------------------|--|------------------|--------|---------------------------|-----------------|-------|-------|-------|-------|------|------|
|                       |  |                  | 18–19  | 19–20                     | 20–21           | 21–22 | 22–23 | 23–24 | 24–25 |      |      |
| Stephen Knolls School |  | Program Capacity | 122    | 122                       | 122             | 122   | 122   | 122   | 122   |      |      |
|                       |  | Enrollment       | 84     | 86                        | 86              | 86    | 86    | 86    | 86    |      |      |
|                       |  | Available Space  | 38     | 36                        | 36              | 36    | 36    | 36    | 36    |      |      |
|                       |  | Comments         |        |                           |                 |       |       |       |       |      |      |
| Longview School       |  | Program Capacity | 56     | 56                        | 56              | 56    | 56    | 56    | 56    |      |      |
|                       |  | Enrollment       | 56     | 56                        | 56              | 56    | 56    | 56    | 56    |      |      |
|                       |  | Available Space  | 0      | 0                         | 0               | 0     | 0     | 0     | 0     |      |      |
|                       |  | Comments         |        |                           |                 |       |       |       |       |      |      |
| RICA                  |  | Program Capacity | 180    | 180                       | 180             | 180   | 180   | 180   | 180   |      |      |
|                       |  | Enrollment       | 100    | 100                       | 100             | 100   | 100   | 100   | 100   |      |      |
|                       |  | Available Space  | 80     | 80                        | 80              | 80    | 80    | 80    | 80    |      |      |
|                       |  | Comments         |        |                           |                 |       |       |       |       |      |      |
| Rock Terrace School   |  | Program Capacity | 76     | 76                        | 76              | 128   | 128   | 128   | 128   |      |      |
|                       |  | Enrollment       | 97     | 93                        | 93              | 93    | 93    | 93    | 93    |      |      |
|                       |  | Available Space  | (21)   | (17)                      | (17)            | 35    | 35    | 35    | 35    |      |      |
|                       |  | Comments         |        |                           | Rev/Ex Complete |       |       |       |       |      |      |
| Carl Sandburg Center  |  | Program Capacity | 79     | 135                       | 135             | 135   | 135   | 135   | 135   |      |      |
|                       |  | Enrollment       | 92     | 93                        | 93              | 93    | 93    | 93    | 93    |      |      |
|                       |  | Available Space  | (13)   | 42                        | 42              | 42    | 42    | 42    | 42    |      |      |
|                       |  | Comments         |        | Rev/Ex Complete Jan. 2020 |                 |       |       |       |       |      |      |
| Cluster Information   |  | Utilization      | 84%    | 75%                       | 75%             | 69%   | 69%   | 69%   | 69%   |      |      |
|                       |  | Enrollment       | 429    | 428                       | 428             | 428   | 428   | 428   | 428   |      |      |

# SPECIAL EDUCATION CENTERS

## Demographic Characteristics of Schools

| Schools                         | 2018-2019        |                     |                       |              |              |              | 2018-2019    |              | 2017-2018         |
|---------------------------------|------------------|---------------------|-----------------------|--------------|--------------|--------------|--------------|--------------|-------------------|
|                                 | Total Enrollment | Two or more races % | Black or Afr. Amer. % | Asian%       | Hispanic %   | White %      | FARMS%*      | ESOL%**      | Mobility Rate%*** |
| Stephen Knolls School SP        | 84               | 0%                  | 29.8%                 | 0%           | 45.2%        | 17.9%        | 39.3%        | 20.2%        | 6.3%              |
| Longview School SP              | 56               | 0%                  | 28.6%                 | 10.7%        | 32.1%        | 28.6%        | 21.4%        | 0%           | 14.8%             |
| Rock Terrace School SP          | 97               | 0%                  | 24.7%                 | 15.5%        | 26.8%        | 28.9%        | 30.9%        | 15.5%        | 12.5%             |
| RICA SP                         | 99               | 6.1%                | 35.4%                 | 0%           | 22.2%        | 34.3%        | 34.3%        | 12.1%        | 72.8%             |
| Carl Sandburg Learning Center S | 92               | 0%                  | 37.0%                 | 7.6%         | 34.8%        | 18.5%        | 50.0%        | 40.2%        | 22.7%             |
| <b>Elementary County Total</b>  | <b>76195</b>     | <b>5.4%</b>         | <b>21.5%</b>          | <b>14.0%</b> | <b>32.7%</b> | <b>26.0%</b> | <b>38.3%</b> | <b>25.6%</b> | <b>13.1%</b>      |

\*Percent of students approved for Free and Reduced-priced Meals Program (FARMS) during the 2018–2019 school year.

\*\*Percent of English for Speakers of Other Languages (ESOL) during the 2018–2019 school year. High School students are served in regional ESOL centers.

\*\*\*Mobility Rate is the number of entries plus withdrawals during the 2017–2018 school year compared to total enrollment.

Notes: Native Hawaiian/Pacific Islander and American Indian/Alaskan Native categories total less than 1% and were therefore excluded from the table.

Due to federal and state guidelines, demographic characteristics of schools of less than or equal to 5 students per category are reported as 0%.

**Program Capacity Table**  
(School Year 2018–2019)

| Schools                         | Special Education Services |             |               |                       |                        |                    |           |           |        |              |          |          |          |         |              |         |          |         |        |       |        |            |         |          |               |           |       |       |         |         |                        |       |
|---------------------------------|----------------------------|-------------|---------------|-----------------------|------------------------|--------------------|-----------|-----------|--------|--------------|----------|----------|----------|---------|--------------|---------|----------|---------|--------|-------|--------|------------|---------|----------|---------------|-----------|-------|-------|---------|---------|------------------------|-------|
|                                 | Capacity (HS @90% MS@85%)  | Total Rooms | Support Rooms | Regular Secondary @25 | Regular Elementary @23 | CSR Grades 1–2 @18 | Pre-K @20 | Pre-K @40 | HS @20 | CSR KIND @18 | KIND @22 | ESOL @15 | METS @15 | HSM @13 | ELEM LAD @13 | ELC @10 | LANG @12 | LFI @10 | SCB @6 | AAC@7 | AUT @6 | BRIDGE @10 | DHOH @7 | SESS @10 | EXTENSIONS @6 | GT/LD @13 | PD @7 | PEP@6 | PEP @12 | PEP @18 | VISION (Elementary) @7 | OTHER |
| Stephen Knolls School SP        | 122                        | 19          | 4             |                       |                        |                    |           |           |        |              |          |          |          |         |              |         | 8        |         |        |       |        |            |         |          |               |           |       | 5     | 1       |         |                        | 1     |
| Longview School SP              | 56                         | 10          | 2             |                       |                        |                    |           |           |        |              |          |          |          |         |              |         |          |         |        |       |        |            |         |          |               | 8         |       |       |         |         |                        |       |
| RICA SP                         | 180                        | 18          |               |                       |                        |                    |           |           |        |              |          |          |          |         |              |         |          |         |        |       |        |            | 18      |          |               |           |       |       |         |         |                        |       |
| Rock Terrace School SP          | 76                         | 16          | 2             |                       |                        |                    |           |           |        |              |          |          |          |         |              |         | 4        |         |        |       | 5      |            |         |          | 1             |           |       |       |         |         |                        | 4     |
| Carl Sandburg Learning Center S | 79                         | 16          | 3             |                       |                        |                    |           |           |        |              |          |          |          |         |              |         |          |         |        | 1     | 12     |            |         |          |               |           |       |       |         |         |                        |       |

# SPECIAL EDUCATION CENTERS

## Facility Characteristics of Schools 2018–2019

| Schools                          | Year Facility Opened | Year Reopened/ Revitalized | Total Square Footage | Site Size Acres | Adjacent Park | Relocatable Classrooms | County Programs |
|----------------------------------|----------------------|----------------------------|----------------------|-----------------|---------------|------------------------|-----------------|
| Stephen Knolls School SP         | 1958                 | 1979                       | 48,872               | 6.6             |               |                        |                 |
| Longview School SP               | 2001                 |                            | 40,362               | 10              |               |                        |                 |
| RICA SP                          | 1977                 |                            | 95,000               | 14.3            |               |                        |                 |
| Rock Terrace School SP           | 1950                 | 1974                       | 48,024               | 10.3            |               |                        |                 |
| Carl Sandburg Learning Center SP | 1962                 |                            | 31,252               | 7.6             |               | 2                      |                 |

### Proposed Site Plan

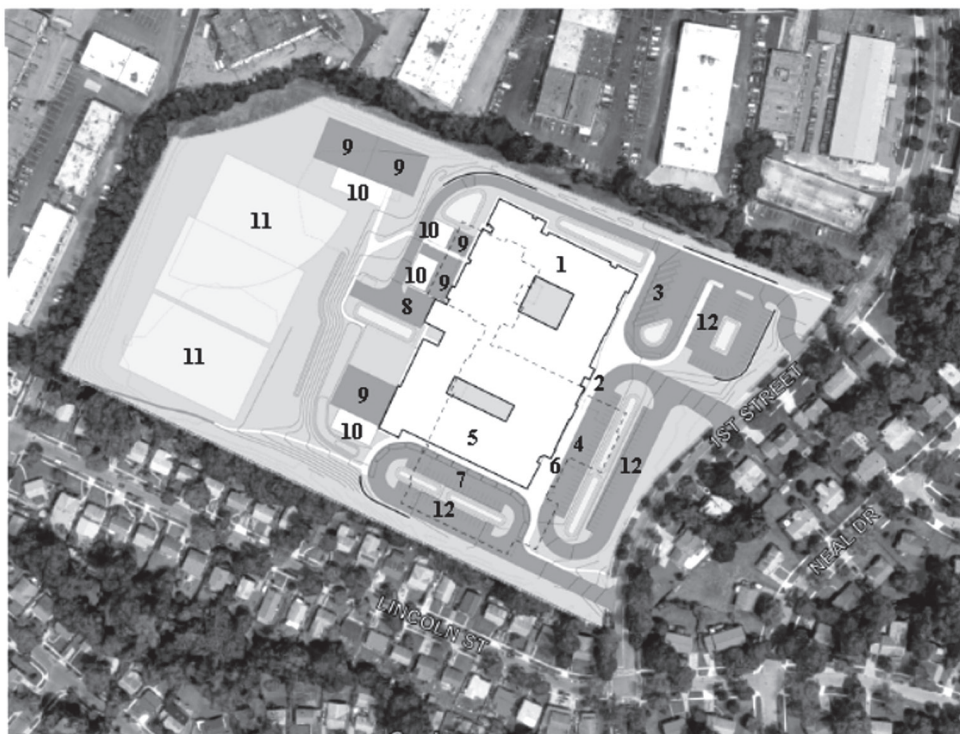

#### LEGEND

- 1 MARYVALE ELEMENTARY SCHOOL
- 2 MARYVALE MAIN ENTRY
- 3 MARYVALE BUS LOOP
- 4 SHARED STUDENT DROP OFF LOOP
- 5 SANDBURG LEARNING CENTER
- 6 SANDBURG MAIN ENTRY
- 7 SANDBURG BUS LOOP
- 8 SERVICE AREA
- 9 PAVED PLAY AREA
- 10 MULCHED PLAY AREA
- 11 ATHLETIC FIELDS
- 12 PARKING

